

Protection 03

Robust preformed asphaltic protective board specially engineered for the protection of GCP self adhesive membranes

Description

The boards are formulated specifically for their purpose using a special blend of cellulose fibers, bitumen and hydrocarbon resins for enhanced strength, resilience and durability.

Manufactured in Europe to a unique specification by a complex process of extrusion and compression, Protection 03 is proven in the field over many years and is recommended by GCP to provide the most suitable and practical protection to all grades of self adhesive membranes.

Installation

Boards shall be laid flat within the pallet prior to the application.

Vertical installation on post applied self adhesive membrane

1. Start at bottom of wall and apply to height of first backfill layer.
2. Wherever possible backfill and compact in layers to minimise risk of displacement of boards.
3. To locate boards, prime five 150 mm x 150 mm 'patches' (one in each corner, and one in the middle) of each board with suitable GCP Primer and allow to dry. Apply Bitustik™ 4000 150 mm double sided bitumen tape to the primed strips. Alternatively a mastic or contact adhesive recommended by GCP can be used to fix the boards.
4. Apply boards to clean dry membrane and roll 'patches' firmly. Remove release film from 'patches' and apply boards to membrane.
5. Once the protection board is fixed in place, subsequent boards shall be laid continuously by butt fitting the edges. Ensure boards stay close butt joints during backfilling and compaction.
6. Provide temporary propping of protection boards where necessary and remove as backfill is placed.

Advantages

- Recommended for use with Bituthene® and backfilled Preprufe® membrane.
- Rot resistant and durable
- High heat resistance - allowing use at elevated temperature in hot climates
- Provides protection to membrane against damage from backfill and site operations
- Robust but lightweight
- High resistance to impact and puncture at elevated temperatures
- Easy to install
- Cold applied

Horizontal protection of self adhesive membrane

Repeat the installation instructions for horizontal protection of membranes.

In high wind conditions provide temporary ballast to the protection boards.

Limitations

Maximum UV exposure of protection boards 30 days. On vertical walls due to the temporary fixing used, backfill is recommended as soon as installation is completed. Not recommended to use with Servidek liquid membrane.

NBS Specification Clause

Refer to Clause J40/380.

Health and Safety

There is no requirement for a Safety Data Sheet for Protection Boards or tapes. For Bituthene® Primer S2, Bituthene® Primer B1 and Preprufe® SC1 read the product label and Safety Data Sheet (SDS) before use. Users must comply with all risk and safety phrases. SDSs can be obtained from GCP Applied Technologies or gcpat.com.

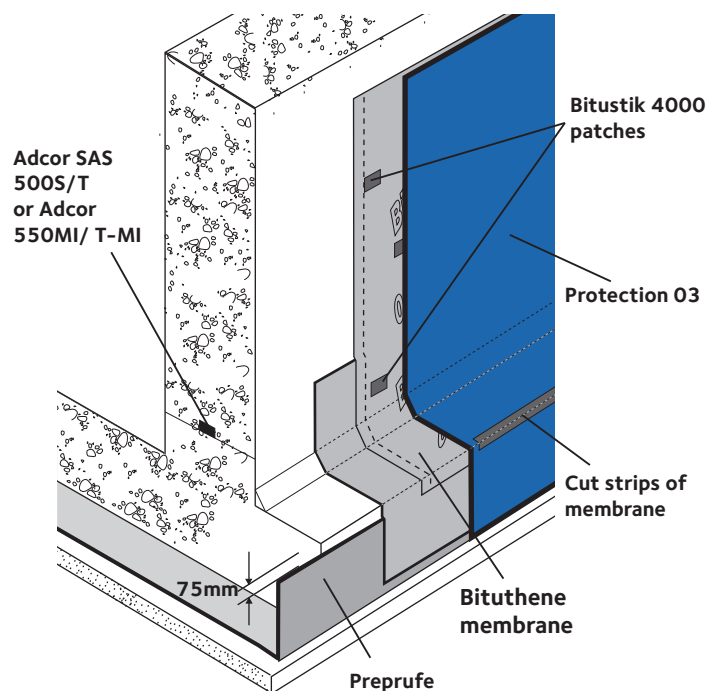

Details shown are typical illustrations only and not working drawings. For assistance with working drawings and additional technical advice please contact GCP Technical Services.

Supply

Protection 03

Length	2.03 m ± 6%
Width	0.90 m ± 6%
Thickness	3.0 mm ± 6%
Nominal Weight	5 kg/board (300 boards per pallet)

Ancillary Products

Bitustik 4000	150 mm x 12 m rolls (6 rolls per carton)
----------------------	--

Typical Properties

	Typical Value	Test Method
Static load, 20 Kg @ +35°C	Pass	EN 12730
Impact Resistance, 80 cm @ +35°C	Pass	EN 12691-A
Puncture Resistance, N		
	+23°C 300 ± 20	ASTM D 4833
	+35°C 225 ± 10	
	+50°C 200 ± 15	
Heat Resistance, +150°C	Pass	EN 1110

All declared values shown in this data sheet are based on test results determined under laboratory conditions and with the product sample taken directly from stock in its original packing without any alteration or modification of its component parts.

gcpat.com | Customer Service: Tel +44 (0)1753 490000 | Fax +44 (0)1753 490001

We hope the information here will be helpful. It is based on data and knowledge considered to be true and accurate, and is offered for consideration, investigation and verification by the user, but we do not warrant the results to be obtained. Please read all statements, recommendations, and suggestions in conjunction with our conditions of sale, which apply to all goods supplied by us. No statement, recommendation, or suggestion is intended for any use that would infringe any patent, copyright, or other third party right.

Adcor, Bituthene, Preprufe and Servidek are trademarks, which may be registered in the United States and/or other countries, of GCP Applied Technologies Inc. This trademark list has been compiled using available published information as of the publication date and may not accurately reflect current trademark ownership or status.

© Copyright 2016 GCP Applied Technologies Inc. All rights reserved.

GCP Applied Technologies Inc., 62 Whittemore Avenue, Cambridge, MA 02140 USA

In the UK, Ipswich Road, Slough, Berkshire, SL1 4EQ, UK

GCP0082_0816 PROTECTION03_UK



gcp applied technologies